

PLEASE CONTACT YOUR TOWN FOR POSSIBLE DRIVEWAY PERMIT AND/OR FEES.

**Oneida County Address Application**  
**Return to your Town with appropriate fees**

**Office use only**

Building Site  
 Existing Dwelling

Municipal Township \_\_\_\_\_  
Driveway Permits Required? Yes No Permit# \_\_\_\_\_

**Contact Information**

Applicants name \_\_\_\_\_ Phone \_\_\_\_\_  
Address \_\_\_\_\_ City \_\_\_\_\_ State \_\_\_\_ Zip \_\_\_\_\_  
Email \_\_\_\_\_ Fax \_\_\_\_\_  
Landowners name \_\_\_\_\_ Phone \_\_\_\_\_  
Address \_\_\_\_\_ City \_\_\_\_\_ State \_\_\_\_ Zip \_\_\_\_\_

**Driveway Information**

Tax Parcel # \_\_\_\_\_ Road name \_\_\_\_\_ Side of Road N S E W  
Section \_\_\_\_ Town \_\_\_\_ Range \_\_\_\_ Forty or GL # \_\_\_\_\_  
Subdivision name \_\_\_\_\_ Lot \_\_\_\_ Block \_\_\_\_\_

**IMPORTANT - If any of the information contained on this form is found to be inaccurate, you may be required to change your address at the time of the discovery. The information presented below is accurate to the best of my knowledge.**

**You must indicate the address and accurate distance, each way, from your driveway to the nearest neighbors' driveways. The neighbors can be across the road as long as the closest neighbors are used. Please indicate if you share a driveway with others.**

Neighbor 1 address \_\_\_\_\_ Distance \_\_\_\_\_ Direction \_\_\_\_\_  
Neighbor 2 address \_\_\_\_\_ Distance \_\_\_\_\_ Direction \_\_\_\_\_  
Nearest intersection 1 \_\_\_\_\_ Distance \_\_\_\_\_ Direction \_\_\_\_\_  
Nearest intersection 2 \_\_\_\_\_ Distance \_\_\_\_\_ Direction \_\_\_\_\_

**Sketch**



Name Printed \_\_\_\_\_ Signature \_\_\_\_\_ Date \_\_\_\_\_

**Office Use Only**

Received by \_\_\_\_\_ Date \_\_\_\_\_  
Address \_\_\_\_\_ By \_\_\_\_\_ Date \_\_\_\_\_  
Assigned \_\_\_\_\_  
Verified by \_\_\_\_\_ Date \_\_\_\_\_ Address Compliant? Yes No

# Instructions

## Contact Information

1. *Applicants* – Provide your name, present phone, fax, email and address information.
2. *Land Owners* – Provide the owners name, phone and address information if it differs from the applicant's info.

## Driveway Information (most of the following information can be obtained from your tax bill)

1. *Pin#* - Provide the parcel identification number shown on your tax bill for the parcel of land containing the intersection of the driveway and the road.
2. *Road name, Side of road* – Provide the Road name and circle the side of the road that the driveway is on.
3. *Section, Town, Range, Forty or GL#* – Provide the section, township, range and forty or GL# (i.e. NWSE, GL3, etc.) that the driveway/road intersection is located.
4. *Subdivision Plat Name, Lot and Block* – Specify the lot, block and subdivision name of the driveway parcel, if applicable and indicated on your tax bill.
5. *Neighbors*– Provide the addresses, distances and directions to the two nearest neighbors' driveways **on either side of the road** OR
6. *Intersection-if closer than a neighbor*, measured along the road, **in both directions** use either neighbors or intersections **WHICHEVER IS CLOSEST.**

## Building Information

1. *Building type* – Provide the building type for building receiving the address with this application (house, commercial building, etc...).
2. It is only necessary to fill out the other lines in this section if the information is different from the information for the driveway.

**Sketch** – Please draw a sketch of the location of your driveway as accurately as possible. This sketch should show the following items:

1. Show the distances between your driveway and you neighbors' driveways or road intersections.
2. Driveway information -see sample sketch below. Make sure your distances are accurate to the nearest 10'
3. Miscellaneous information – Must have the compass shown with directions, any other explanatory text that would be helpful, etc...)

## Sample Sketch

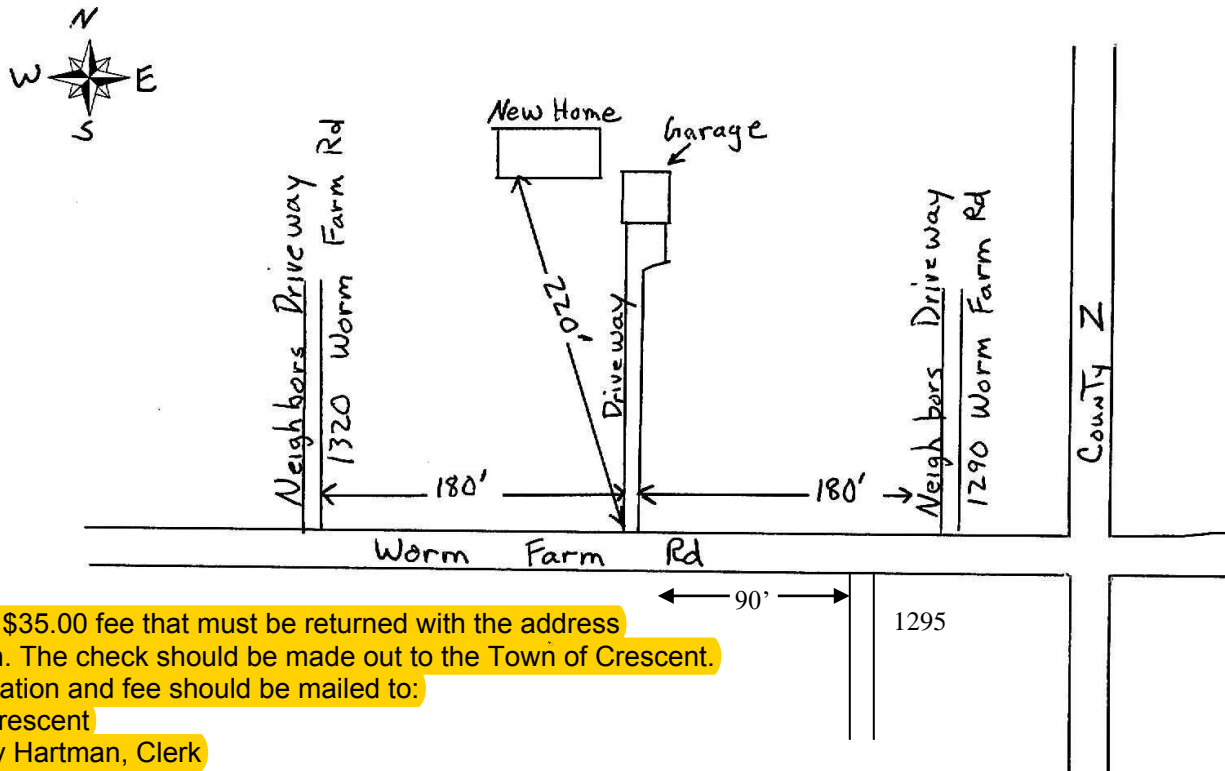

There is a \$35.00 fee that must be returned with the address application. The check should be made out to the Town of Crescent.

The application and fee should be mailed to:

Town of Crescent

Attn: Tracy Hartman, Clerk

6902 Fire Tower Rd

Rhineland, WI 54501